

Temper

Technical Rider

Stage setup

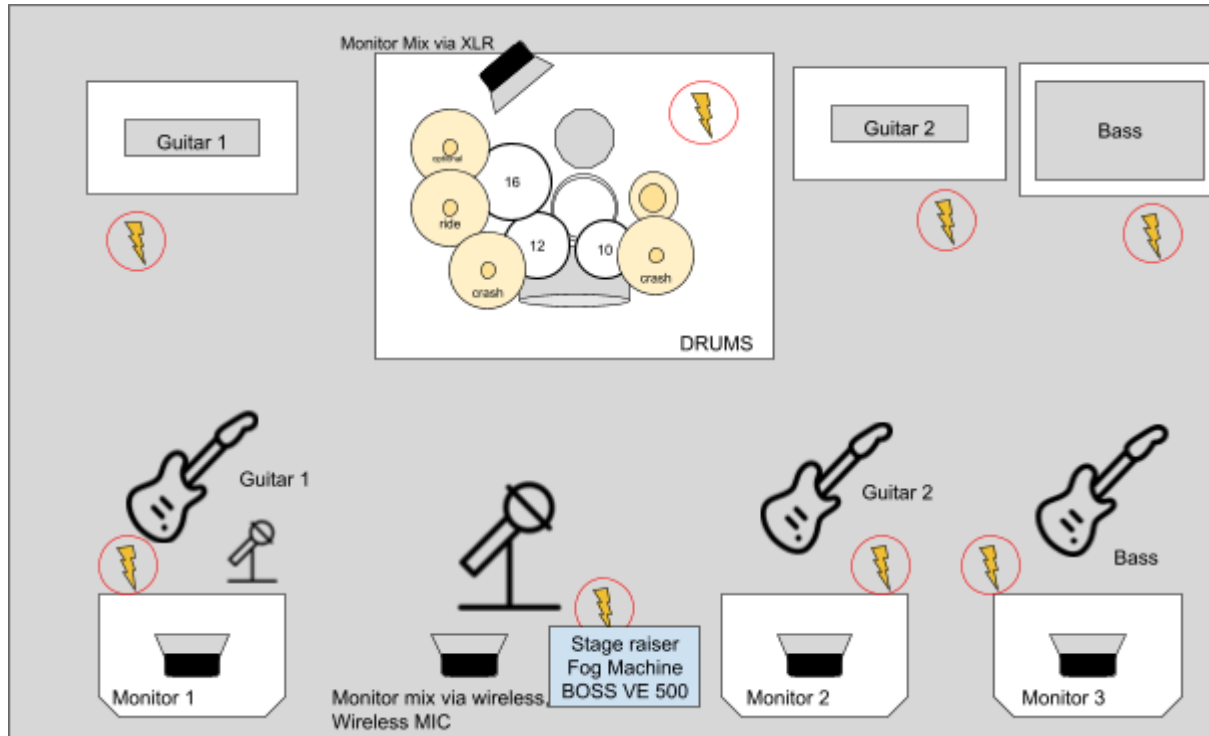

Line Up Stage

1 x Drums, 1 x Bass Guitar, 2 x Guitar (each using 1 cab!), 2 x Vocals (main and background)

Drums (Chris)		
		Sontiges
Venue:	Bassdrum 22" Toms 10", 12", 16" Hardware (4 Beckenständer, HH Ständer), Hocker	Power AUX Monitor mix
Temper:	Becken, Snare, Fußmaschine	Monitor: In-Ear

Bass (Kenan)		
	1 Bass Combo	Sontiges
Venue:	To be aligned	Power

Temper:	To be aligned	1x XLR from floor board (POD GO) to FoH Sound to front and bass amp goes out of POD GO modeller via XLR (mixer) and cable (amp)
---------	---------------	--

Guitar 1 (Sören)		
	1 Guitar Amp	Sontiges
Venue:	To be aligned	Power Microphone + stand for background vocals
Temper:	To be aligned	

Guitar 2 Lucas		
	1 Guitar Amp	Sontiges
Venue:	To be aligned	Power optional microphone + stand
Temper:	To be aligned	

Vocals (Frank)		
		Sontiges
venue:	n/a	4x power connections 2x Monitor mix to connect wireless sender & effects
Temper:	1x Mic stand 1x wireless Mic 1x Boss VE500	Fog Machine and Ego Riser (box) In Ear monitor

Additional audio signals to FOH

2x XLR for Singer (Boss VE500)

Additional audio signals from FOH to stage

1x Monitor Guitar 1, Singer, Bassdrum via XLR to Drumset

1x Monitor Guitar and vocals via In Ear Monitoring to Singer